



2 Richmond Place, Lowestoft, Suffolk, NR33 0EW

**** IDEAL FAMILY HOME **** Situated walking distance to the beach and local amenities within SOUTH Lowestoft is this 3 double bedroom mid terrace property, set across 3 floors, boasting a ground floor WC/Utility, sitting room, dining room and front and rear gardens!

- Ideal family home
- Set across 3 floors
- Walking distance to the beach
- Separate sitting room and dining room
- Ground floor WC/Utility
- Private rear garden
- Separate entrance hall
- Close to local amenities
- Gas central heating
- 3 Double bedrooms

£875

GROUND FLOOR
527 sq.ft. (49.0 sq.m.) approx.

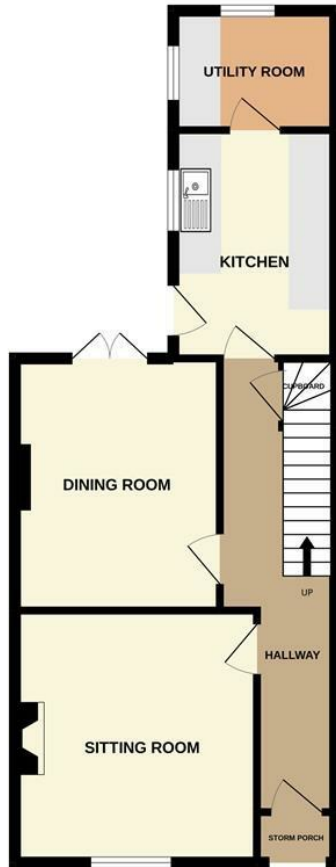

1ST FLOOR
478 sq.ft. (44.4 sq.m.) approx.



2ND FLOOR
203 sq.ft. (18.8 sq.m.) approx.

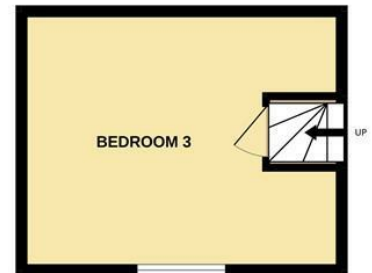

TOTAL FLOOR AREA : 1207 sq.ft. (112.2 sq.m.) approx.

Whilst every attempt has been made to ensure the accuracy of the floorplan contained here, measurements of doors, windows, rooms and any other items are approximate and no responsibility is taken for any error, omission or mis-statement. This plan is for illustrative purposes only and should be used as such by any prospective purchaser. The services, systems and appliances shown have not been tested and no guarantee as to their operability or efficiency can be given.
Made with Metropix ©2022

